

# INSTALLATION AND MAINTENANCE



**CT-9005**

Designed to be placed on the pipe under the insulation and padding



⚠	<b>DANGER</b>	⚠
<b>ELECTRIC SHOCK OR FIRE HAZARD</b>		
READ ALL WIRE SIZING, VOLTAGE REQUIREMENTS AND SAFETY DATA TO AVOID PROPERTY DAMAGE AND PERSONAL INJURY		

## LOW PROFILE END SEAL KIT

Item	Qty	Description
A	1	Seal plate for Main Box
B	1	Main End Seal Box
C	1	(color) Grommets
D	1	Label

RATING	NEMA TYPE 4X	
CERTIFICATION		Class I, Div. 2, Groups A, B, C, D <sup>[2]</sup> Class II, Div. 2, Groups E, F, G <sup>[2]</sup> Class III <sup>[2]</sup>

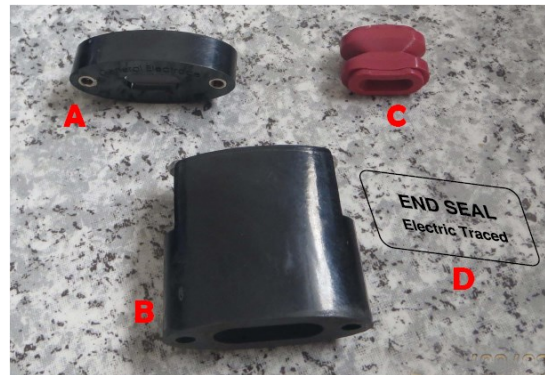

## ⚠ WARNING ⚠

- If after carefully reading these instructions you still have questions regarding installation or operation of this product, call King Electrical Manufacturing Co. at 206-762-0400 or visit us at [www.king-electric.com](http://www.king-electric.com) for assistance.
- This component is an electrical device which must be installed correctly to ensure proper operation and to prevent shock or fire. Read these important warnings and carefully follow all of the installation instructions.
- To minimize the danger of fire from sustained electrical arcing if the heating cable is damaged or improperly installed, and to comply with the requirements of King Electrical, certifications, and National Electrical Codes, ground-fault equipment protection must be used. Arcing may not be stopped by conventional circuit breakers.
- Component approvals and performance are based on the use of King Electrical. specified parts only. Do not use substitute parts or vinyl electrical tape.
- The black heating cable core is conductive and can short. It must be properly insulated and kept dry.
- Damaged bus wires can overheat or short. Do not break bus wire strands when scoring the jacket or core.
- Keep components and heating cable ends dry before and during installation
- Bus wires will short if they contact each other.
- Keep bus wires separated.

# INSTALLATION INSTRUCTIONS

## CT-9005 Installation Instructions

**1**

- Identify heating cable type.
- Select correct grommet from table below

Heating Cable	Type	Grommet
SR	--CT	RED

\* Order separately

**WARNING:** Use of the wrong grommet can result in leaks, cracked components, shock or dielectric failure, and will invalidate approvals and certifications

Structure of Model HTR-CR

**2**

- Insert first the (Pressure Seal End) then the (Grommet) into the cable.

**3**

- Do not cut the braiding

- Denude the outer jacket
- Slightly bend the cable where you made the cut

**4**

- Remove excess braiding

**5**

- Insert the heating cable into the main box
- Install the grommet into position
- Screw the Pressure seal end into the main box

**6**

- Fix the Low profile End Seal and side wires to the pipe with tape
- Install insulation
- Install label on the insulation protector
- Give instruction to the owner/user

